

Our ref: WR25/32480

21 October 2025

Chief Executive Officer
Western Downs Regional Council
PO Box 551
DALBY, QLD 4350
angusmunro@arcosgroup.com.au

Attention: Angus Munro

Dear Mr Munro

Exemption certificate given

The State Assessment and Referral Agency (SARA) received your request for an exemption certificate for the development described below on 14 October 2025.

Under section 46(2)(b) of the *Planning Act 2016*, SARA agrees to issue an exemption certificate for the development described below.

Applicant details

Applicant name:	Western Downs Regional Council
Applicant contact details:	PO Box 551 Dalby QLD 4350 angusmunro@arcosgroup.com.au

Premises details

Street address:	280 Old Rosevale Road, Jandowae
Real property description:	Lot 1 on RP123836
Local government area:	Western Downs Regional Council
Premises Owner:	Western Downs Regional Council

Development details

Operational work for constructing or raising waterway barrier works in fish habits being operational work involving modifications to the Jandowae Dam spillway in accordance with the following plans/specifications:

Plans/specifications	Prepared by	Date	Reference no.	Version/issue
Aspect of development: Operational work – constructing or raising waterway barrier works in fish habitats				
Spillway Works Plan	GHD	15 May 2018	41-31652-C001	Rev: 0
Spillway Works Sections and Detail	GHD	15 May 2018	41-31652-C001	Rev: 0
Jandowae Dam Spillway Works Design Report	GHD	July 2018	4131652	-

Referral agencies

Not applicable.

Assessable development

This exemption certificate relates to the following provisions of the Planning Regulation 2017:

- Schedule 8, Table 4, Item 3 (m)– Operational work that is constructing or raising waterway barrier works.

Assessable development

This exemption certificate is given as the effects of the development would be minor or inconsequential, considering the circumstances under which the development was categorised as assessable development.

When exemption certificate ceases to have effect

Pursuant to section 46(8) of the *Planning Act 2016* this exemption certificate has effect for two years.

For further information please contact Rodney O'Brien, Principal Planning Officer, on 07 46167304 or via email toowoombasara@dsdip.qld.gov.au who will be pleased to assist.

Yours sincerely



Karley Lawler
Director
Planning Services
Department of State Development, Infrastructure and Planning

Darling Downs South West regional office
128 Margaret Street, Toowoomba
PO Box 825, Toowoomba QLD 4350

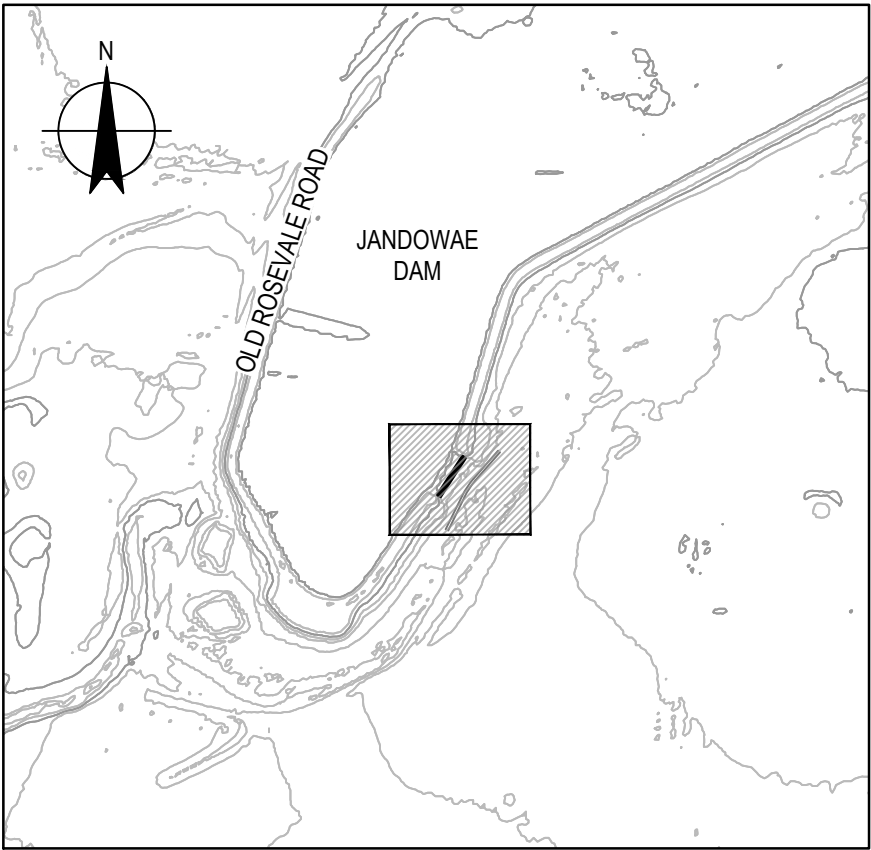
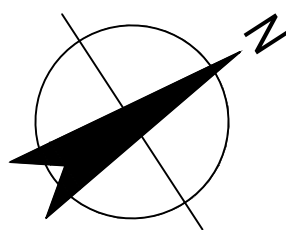

KEY PLAN
NOT TO SCALE

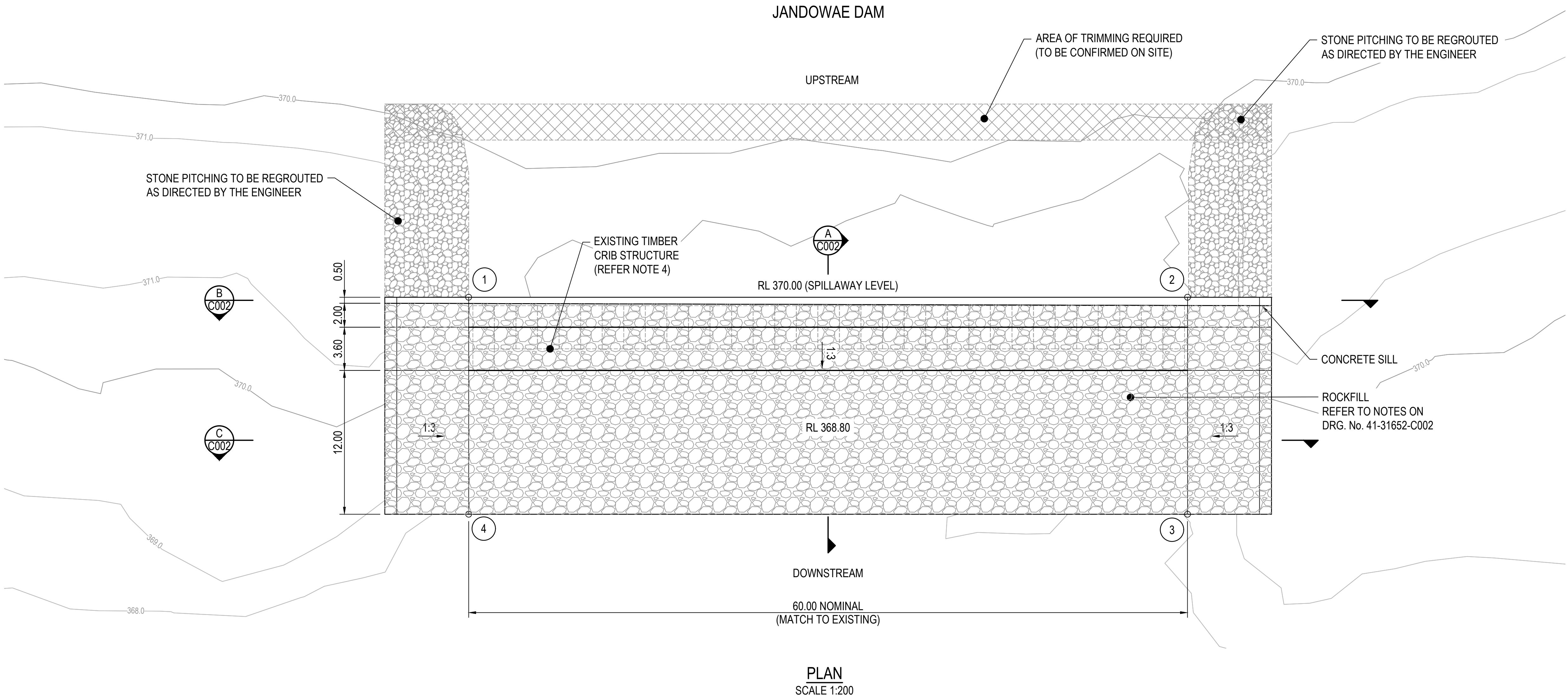

SETOUT POINTS		
POINT	EASTING	NORTHING
1	315008.837	7038727.566
2	315041.596	7038777.833
3	315056.760	7038767.951
4	315024.001	7038717.683

LOCATION TO BE
CONFIRMED ON SITE

NOTES:

1. CONTOURS HAVE BEEN PRODUCED FROM 1m LIDAR SURVEY POINTS RECEIVED FROM WDRC ON 8/8/2017.
2. REFER TO ENGINEER FOR ANY DISCREPANCIES WITH THE DRAWINGS PRIOR TO WORK COMMENCING. IF UNSURE, ASK.
3. ALL DIMENSIONS ARE IN METRES AND LEVELS ARE TO AUSTRALIAN HEIGHT DATUM.
4. EXISTING TIMBER SILL AND TIMBER CRIB STRUCTURE TO BE REMOVED IN STAGES.
5. DRAWINGS MUST BE READ IN CONJUNCTION WITH THE SPECIFICATION.

FOR CONSTRUCTION

0	FOR CONSTRUCTION		EC	RC*	LD*	15.05.18
No	Revision	Note: * indicates signatures on original issue of drawing or last revision of drawing	Drawn	Job Manager	Project Director	Date



145 Ann St Brisbane QLD 4000 Australia
GPO Box 668 Brisbane QLD 4001
T 61 7 3316 3000 F 61 7 3316 3333
E bnemail@ghd.com W www.ghd.com

DO NOT SCALE

Conditions of Use.
This document may only be used by
GHD's client (and any other person who
GHD has agreed can use this document)
for the purpose for which it was prepared
and must not be used by any other
person or for any other purpose.

Drawn J. BARCIAL

Designer L. MARTIN

Drafting G. DOUGHERTY*

Design R. CANTRILL*

Approved (Project Director) L. DELAERE*

Date 15 MAY 2018

Scale 1:200

This Drawing must not be
used for Construction unless
signed as Approved

Client WESTERN DOWNS REGIONAL COUNCIL
Project JANDOWAE DAM
Title SPILLWAY WORKS
PLAN

Original Size
A1 Drawing No: 41-31652-C001

Rev: 0

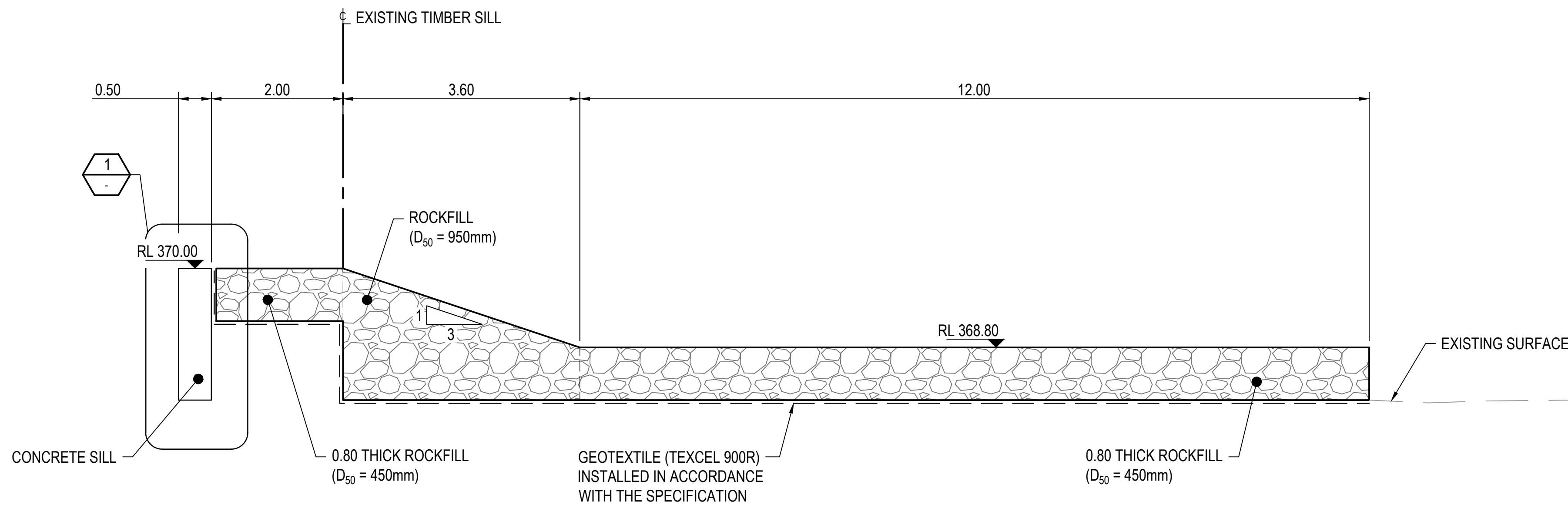

A SECTION - SPILLWAY
C001 SCALE 1 : 50

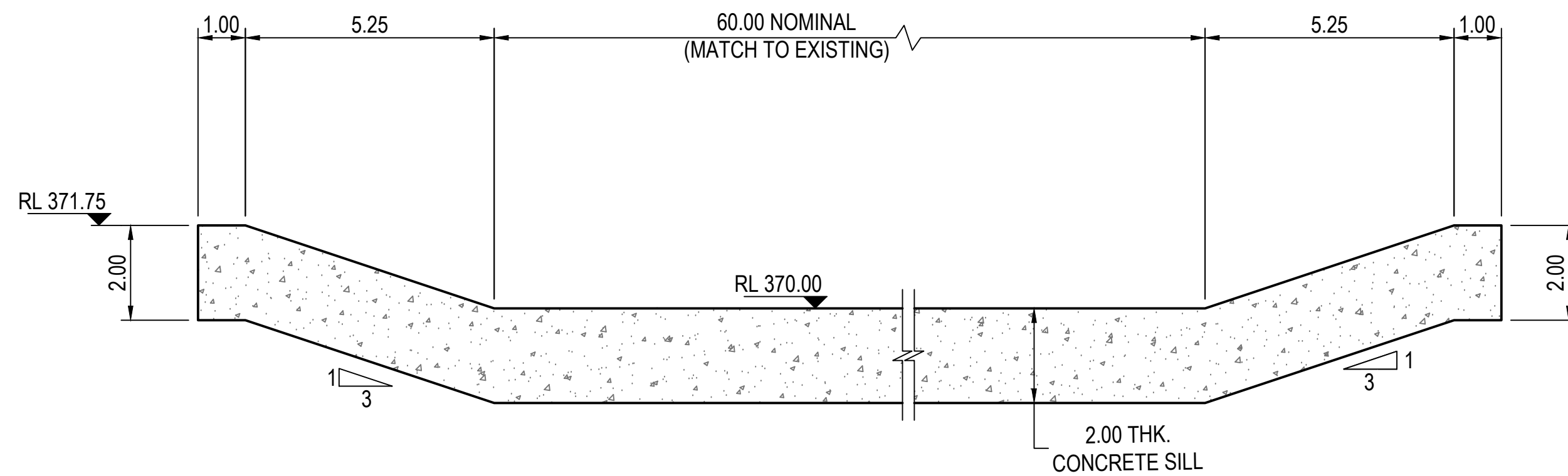
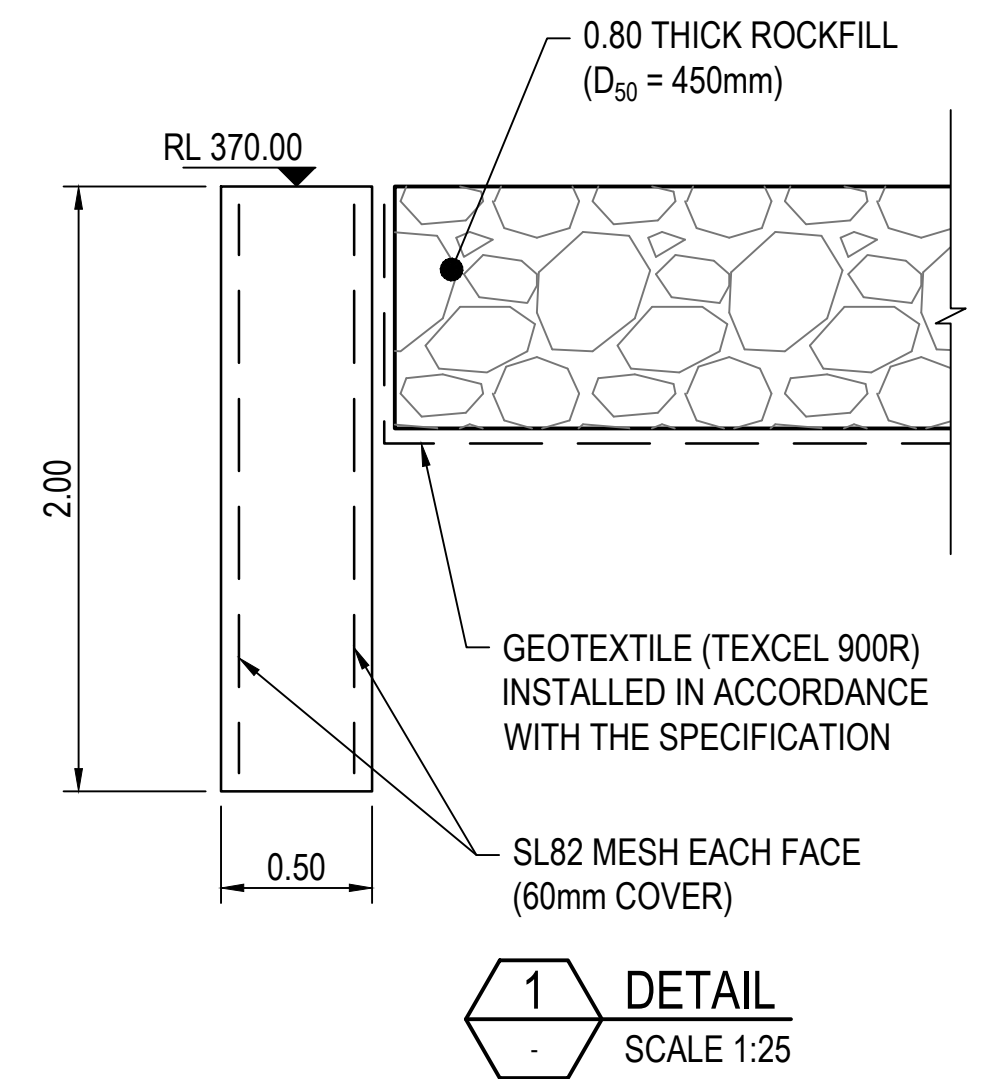

B SECTION - CONCRETE SILL
C001 SCALE 1 : 100

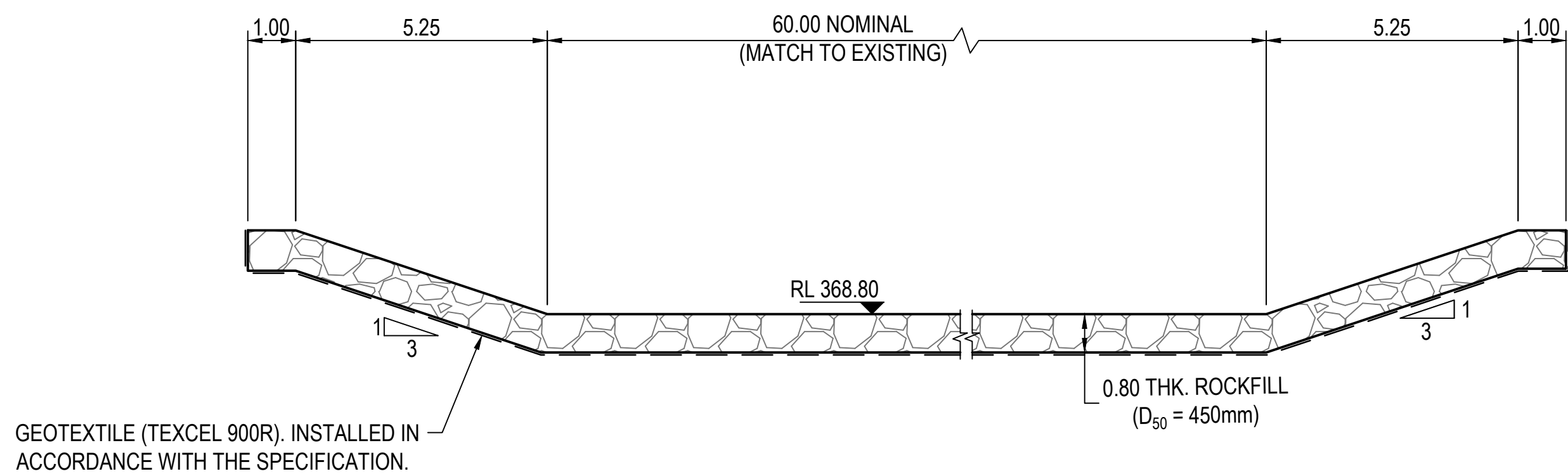

C SECTION - SPILLWAY CHUTE
C001 SCALE 1 : 100

NOTES:

1. ROCK SIZES OF $D_{50} = 950\text{mm}$ AND $D_{\text{max}} = 1440\text{mm}$ ARE REQUIRED FOR DURABILITY. OTHERWISE, MINIMUM $D_{50} = 450\text{mm}$ AND $D_{\text{max}} = 650\text{mm}$. REFER TO DESIGN REPORT.
2. IF LARGER MATERIAL IS TO BE UTILISED, CHANGES TO THE DESIGN ARE REQUIRED, CONTACT ENGINEER.
3. IF SMALLER MATERIAL IS UTILISED THERE IS A RISK OF DAMAGE TO THE UNDERLYING EMBANKMENT.
4. CONCRETE GRADE N40.

FOR CONSTRUCTION

0	FOR CONSTRUCTION		JB	RC*	LD*	15.05.18
No	Revision	Note: * indicates signatures on original issue of drawing or last revision of drawing	Drawn	Job Manager	Project Director	Date

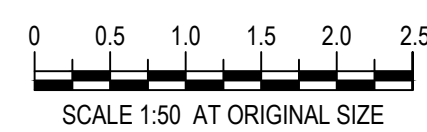
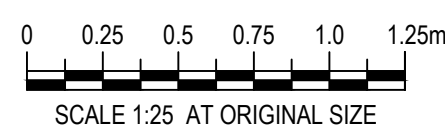
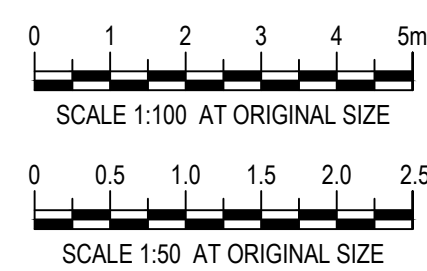

145 Ann St Brisbane QLD 4000 Australia
GPO Box 668 Brisbane QLD 4001
T 61 7 3316 3000 F 61 7 3316 3333
E bnemail@ghd.com W www.ghd.com

DO NOT SCALE

Conditions of Use.
This document may only be used by GHD's client (and any other person who GHD has agreed can use this document) for the purpose for which it was prepared and must not be used by any other person or for any other purpose.

Drawn	E. CASILE	Designer	L. MARTIN
Drafting Check	G. DOUGHERTY*	Design Check	R. CANTRILL*
Approved (Project Director)	L. DELAERE*	Date	15 MAY 2018
Scale	AS SHOWN	This Drawing must not be used for Construction unless signed as Approved	

Client	WESTERN DOWNS REGIONAL COUNCIL
Project	JANDOWAE DAM
Title	SPILLWAY WORKS SECTIONS AND DETAIL
Original Size	A1
Drawing No:	41-31652-C002
Rev:	0